

HAYWARD SUPER PUMP

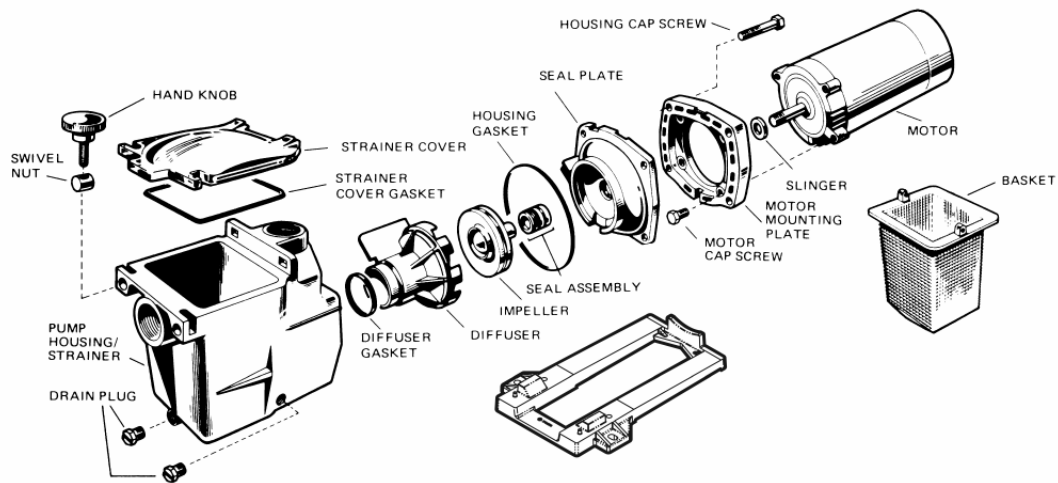

SUPER PUMP

Part No.

Description

SPX1600AA	Pump Housing/Stainer, 1 1/2" x 1 1/2", w/Drain Plugs
SPX1620AA	Pump Housing/Stainer, 2" x 2", w/Drain Plugs
SPX1600T	Housing Gasket
SPX1600R	Diffuser Gasket
SPX1600D	Strainer Cover, clear
SPX1600S	Strainer Cover Gasket
SPX1600M	Basket
SPX1600PN	Hand Knob Kit (includes Swivel Nut and Hand Knob)
SPX1600V	1/4" Drain Plug (1991- prior)
SPX1700FG	1/4" Drain Plug w/Gasket (1992 and later)
SPX2600G1	Mounting Foot w/Adapter and Screws
SPX1600Z52	Mounting Foot Cap Screw (<i>Set of 2 – 2 Sets Required</i>)
SPX1600F5	Motor Mounting Plate

SPX1600Z4	Housing Cap Screw
SPX2600B	Diffuser, for 1/3 thru 1 1/2 H.P.
SPX1616B	Diffuser, for 2 H.P. only
SPX2600C	Impeller, for 1/3 H.P.
SPX2605C	Impeller, for 1/2 H.P.
SPX2607C	Impeller, for 3/4 H.P.
SPX2610C	Impeller, for 1 H.P.
SPX2615C	Impeller, for 1 1/2 H.P.
SPX1621C	Impeller, for 2 H.P.